

MAHAGUN



MONTAGE
2/3/4/5 BHK HOMES CROSSINGS REPUBLIK

SIMPLY LUXURIOUS



"It's time to gather the pieces of life
for eternal happiness
at Mahagun Montage."

Hafeez Contractor
Design Consultant

SIMPLY LUXURIOUS

Luxury is a state of affluence and grace. Mahagun Montage is designed with the vision to deliver luxury in its purest, yet simplest form. It is a fine balance of Innovative Architecture and aesthetics, designed to bring the homespun feeling of warmth and conviviality. With plenty of features space, Montage offers the perfect home for those who expect the best of economy living.



CROSSINGS REPUBLIK

A WORLD CLASS LOCATION

Crossing Republik, India's first global city spread out in 360 acres, is planned to bring a whole new world within an arm's distance not just for you and your family, but for your coming generations as well with world-class ambience, meticulous design, premium infrastructure and futuristic facilities within the premises.

Crossings Republik has been designed by the world's finest architecture firm, Sasaki Associates Inc., who have dotted the entire world with brilliant pieces of their ingenuity.

- Approved freehold property with vastu compliant projects
- Centrally located with convenient approach located between GZB, Noida & Greater Noida on NH 24
- 360 Acres of township endowed with malls, retail outlets, office spaces, hospital, banks, schools etc.
- 100% Power Backup along with 24 Hour water supply
- Elaborate public utilities like High Capacity Bus Transport Sys., Post Office, Police Station, Fire Station
- 9 hole Golf Course within the township





Mahagun Montage

We present to you a place you will always cherish. A fusion of amenity and luxury conceptualized to make your living picture perfect. Montage is your heaven etched with love and care by Mahagun, a name that performs. A perfect destination for you and your family to relax, unwind and connect.

CROSSINGS
Republik *Golf Club*

GOLF COURSE

CROSSINGS REPUBLIK

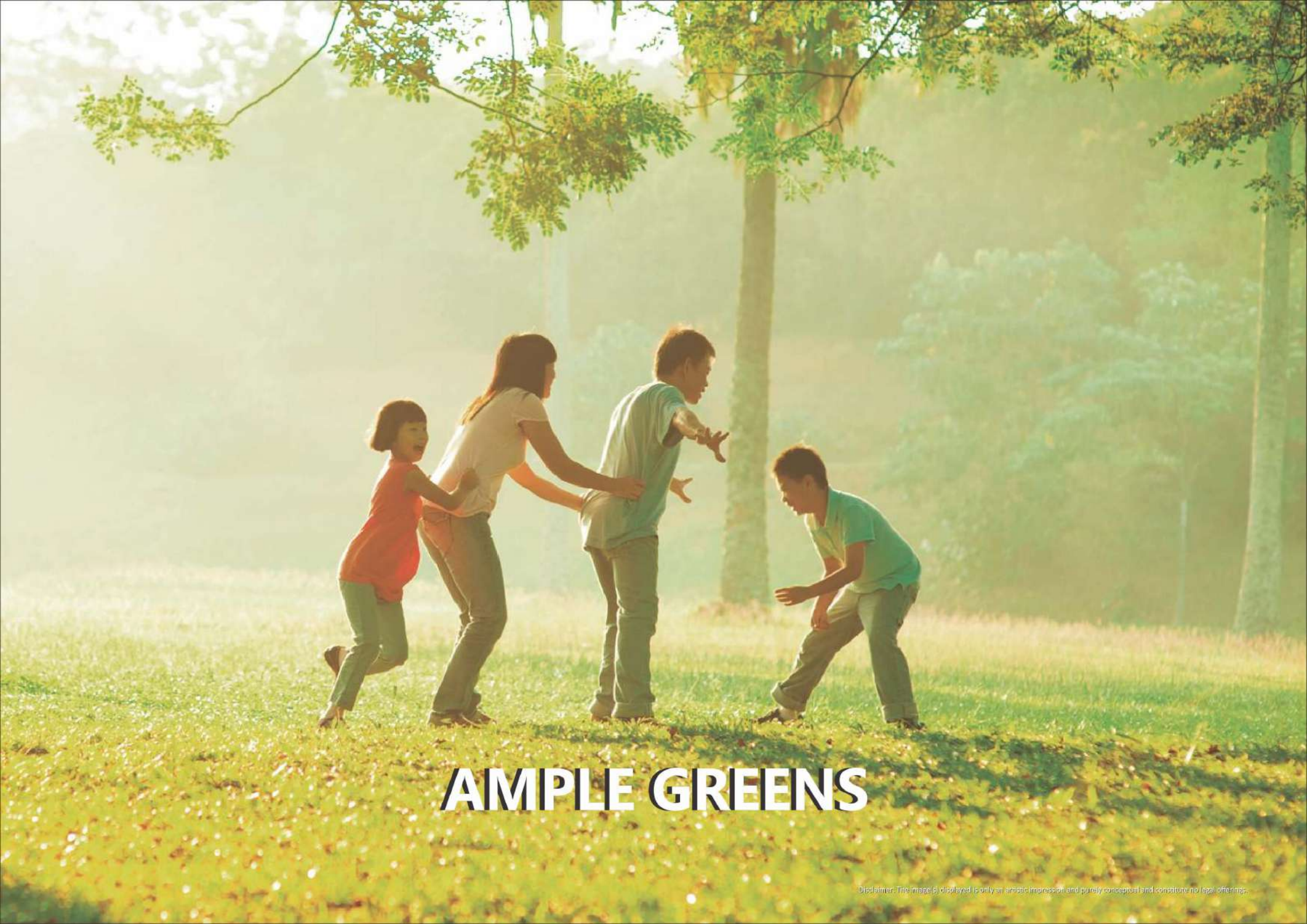

AMPLE GREENS

Disclaimer: The image(s) displayed is only an artistic impression, and purely conceptual and constitute no legal offering.



CLUB HOUSE

Disclaimer: The image(s) displayed is only an artistic impression and purely conceptual and constitute no legal offerings.



画区地下一层

COVERED PARKING

- LEGEND**
- A. MAIN ENTRY EXIT
 - B. ENTRY WATER BODY
 - C. GUARD HOUSE
 - D. TOWER DROP OFF
 - E. MULTI PURPOSE COURT
 - F. KIDS / SHALLOW POOL
 - G. POOL
 - H. DECK
 - I. ELDER'S SEATING
 - J. LAWN / LANDSCAPED GREEN
 - K. BADMINTON COURT
 - L. PATHWAY WITH SEAT WALL
 - M. KIDS PLAY ZONE / THEME PARK
 - N. ASSEMBLY COURT
 - O. PRETEEN AREA
 - P. JOGGING TRACK
 - Q. AMPHITHEATER



Disclaimer : The depiction of images of layout and features as mentioned above are based on artistic impression. The customers are advised to check and re-verify the layout and features as mentioned from the website of RERA and/or from the office of the Developer.

CONCEPT LANDSCAPE DESIGN



MIG-I (2 BHK)

Super Area – 900 sq. ft. / 83.6 sq. mt.
 Carpet Area - 594.8 sq.ft./55.25 sq.mt.
 Balcony Area - 68.90 sq.ft./6.40 sq.mt.
 2 Bedrooms, 2 Toilets, Living/Dining
 Room, Kitchen & Balconies

UNIT NOS.: 1,8,9,17,18,25,26,33

FLOOR: 2 TO 31

UNIT NOS.: 8,9,25,26

FLOOR: 1

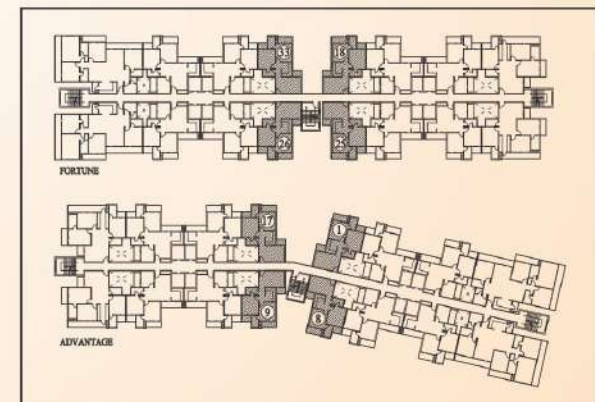

MIG-II (2 BHK)

Super Area – 1117 sq. ft. / 103.77 sq. mt.

Carpet Area - 761.8 sq.ft./70.77 sq.mt.

Balcony Area - 112.15 sq.ft./10.41 sq.mt.

2 Bedrooms, 2 Toilets, Living/Dining
Room, Kitchen & Balconies

UNIT NOS.: 14,21

FLOOR: 9,17,24,31

UNIT NOS.: 12,22

FLOOR: 5,14,21,28

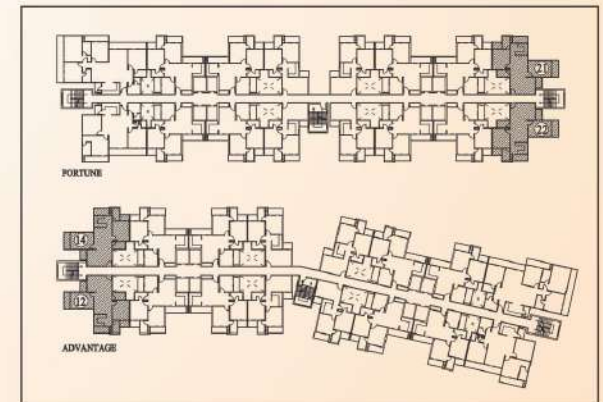

HIG-I (2 BHK + St. Room)

Super Area – 1120 sq. ft. / 104.05 sq. mt.

Carpet Area - 723.7 sq.ft./67.23 sq.mt.

Balcony Area - 130.45 sq.ft./12.11 sq.mt.

2 Bedrooms+1 St. Room, 2 Toilets,
Living/Dining Room, Kitchen & Balconies

UNIT NOS.: 2,3,6,7,10,11,15,16,19,20

23,24,27,28,31,32

FLOOR: 2 TO 31

UNIT NOS.: 2,3,6,7,10,11,15,16,24

27,28,31,32

FLOOR: 1

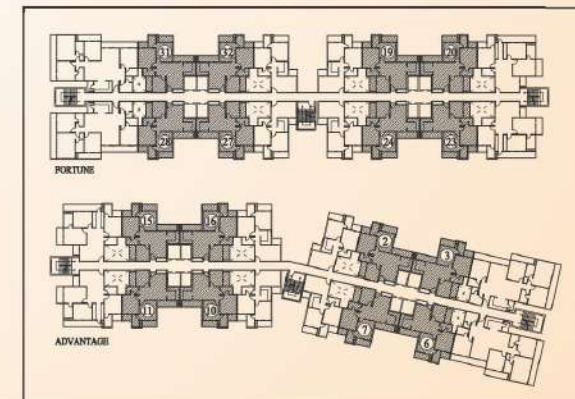

Disclaimer: The depiction of images of layout and features as mentioned above are based on artistic impression. The customers are advised to check and re-verify the layout and features as mentioned from the website of RERA and/ or from the office of the Developer. 1 sq. mtr. = 10.764 sq. ft.

HIG-II (3 BHK)

Super Area - 1380 sq. ft. / 128.2 sq. mt.
 Carpet Area - 903 sq.ft./83.89 sq.mt.
 Balcony Area - 162.25 sq.ft./15.07 sq.mt.
 3 Bedrooms, 3 Toilets, Living/Dining
 Room, Kitchen & Balconies

UNIT NOS.: 12,22

FLOOR: 2,6,7,8,9,10,15,16,17,
18,22,23,24,25,29,30,31

UNIT NOS.: 14,21

FLOOR: 2,3,4,5,6,10,11,12,14,
18,19,20,21,25,26,27,28

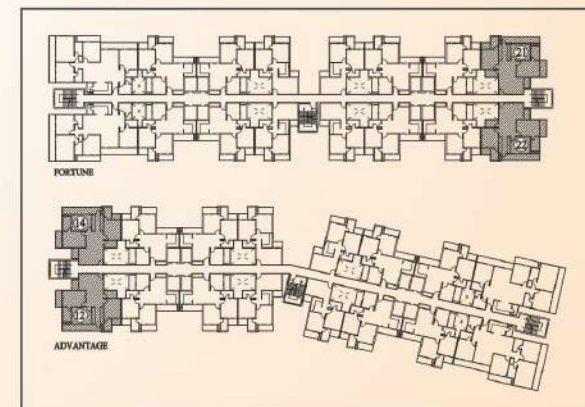

Disclaimer: The depiction of images of layout and features as mentioned above are based on artistic impression. The customers are advised to check and re-verify the layout and features as mentioned from the website of RERA and/ or from the office of the Developer. 1 sq. mtr. = 10.764 sq. ft.

HIG-III (3 BHK+ St. Room)

Super Area - 1520 sq. ft. / 141.2 sq. mt.

Carpet Area - 1006.75 sq.ft./93.52 sq.mt.

Balcony Area - 147.3 sq.ft./13.68 sq.mt.

3 Bedrooms, 1 St. Room with Toilet, 2 Toilets,
Living/Dining Room, Kitchen & Balconies

UNIT NOS.: 5,29

FLOOR: 5,14,21,28

UNIT NOS.: 4,30

FLOOR: 9,17,24,31

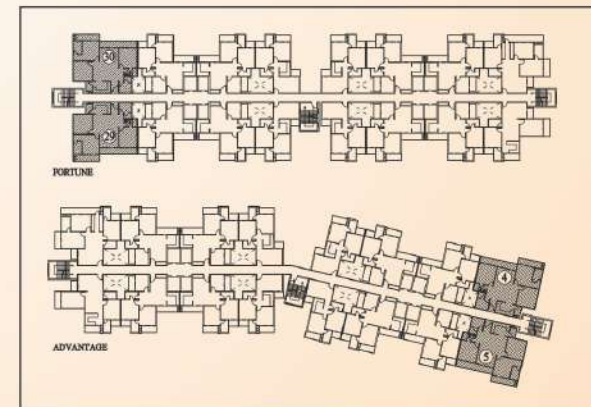

Disclaimer: The depiction of images of layout and features as mentioned above are based on artistic impression. The customers are advised to check and re-verify the layout and features as mentioned from the website of RERA and/ or from the office of the Developer. 1 sq. mtr. = 10.764 sq. ft.

SHIG-I (4 BHK)

Super Area – 2040 sq. ft. / 189.5 sq. mt.
 Carpet Area - 1338.9 sq.ft./124.38 sq.mt.
 Balcony Area - 248.75 sq.ft./23.10 sq.mt.
 4 Bedrooms, 1 St. Room with Toilet,
 3 Toilets, Living/Dining Room, Kitchen
 & Balconies

UNIT NOS.: 5,29

FLOOR: 1,2,6,7,8,9,10,15,16,17
 18,22,23,24,25,29,30,31

UNIT NOS.: 4,30

FLOOR: 1,2,3,4,5,6,10,11,12,14
 18,19,20,21,25,26,27,28

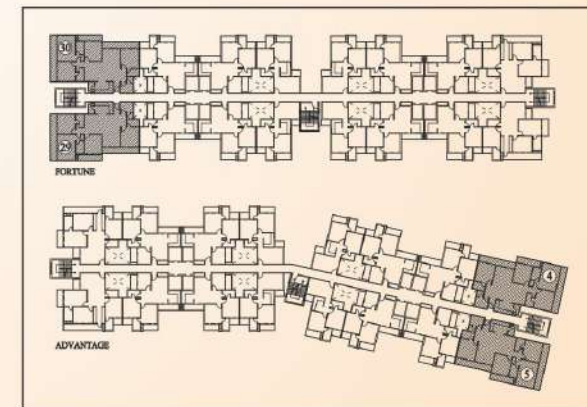

Disclaimer: The depiction of images of layout and features as mentioned above are based on artistic impression.

The customers are advised to check and re-verify the layout and features as mentioned from the website of RERA and/ or from the office of the Developer. 1 sq. mtr. = 10.764 sq. ft.

LOWER LEVEL



DUPLEX-I (4 BHK)

Super Area - 2340 sq. ft. / 217.39 sq. mt.
 Carpet Area - 1499.95 sq.ft./139.34 sq.mt.
 Balcony Area - 148.6 sq.ft./13.80 sq.mt.
 4 Bedrooms, 4 Toilets, Living/Dining Room,
 Family Lounge, Kitchen & Balconies

UNIT NOS.: 12,22

FLOOR: 3,11,19,26

UNIT NOS.: 14,21

FLOOR: 7,15,22,29

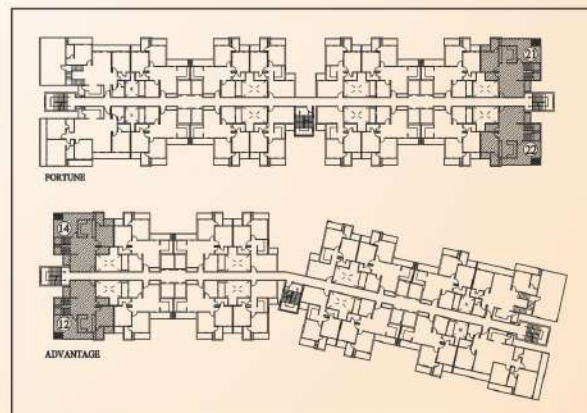

Disclaimer: The depiction of images of layout and features as mentioned above are based on artistic impression.
 The customers are advised to check and re-verify the layout and features as mentioned from the website of RERA and/ or from the office of the Developer. 1 sq. mtr. = 10.764 sq. ft.

UPPER LEVEL

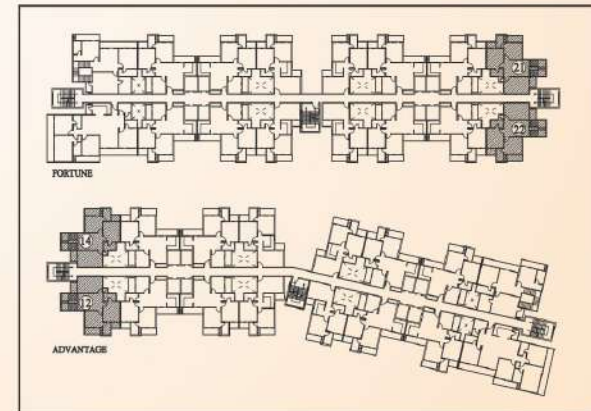

Disclaimer: The depiction of images of layout and features as mentioned above are based on artistic impression. The customers are advised to check and re-verify the layout and features as mentioned from the website of RERA and/ or from the office of the Developer. 1 sq. mtr. = 10.764 sq. ft.

DUPLEX-II (5 BHK)

Super Area – 3440 sq. ft. / 319.5 sq. mt.

Carpet Area - 1997.7 sq.ft./185.59 sq.mt.

Balcony Area - 294.8 sq.ft./27.38 sq.mt.

5 Bedrooms, 1 St. Room with Toilet, 5 Toilets,

Living/Dining Room, Family Lounge,

Kitchen & Balconies

UNIT NOS.: 5,29

FLOOR: 3,11,19,26

UNIT NOS.: 4, 30

FLOOR: 7,15,22,29

LOWER LEVEL

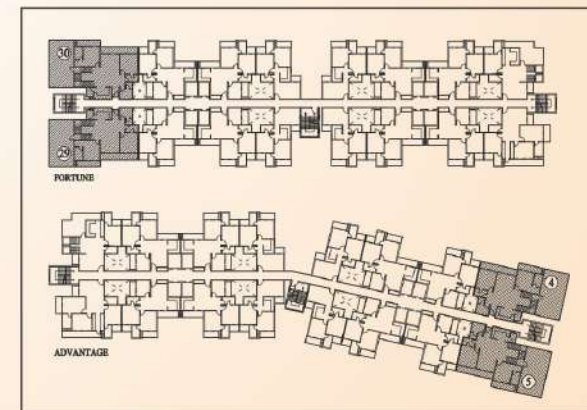

UPPER LEVEL

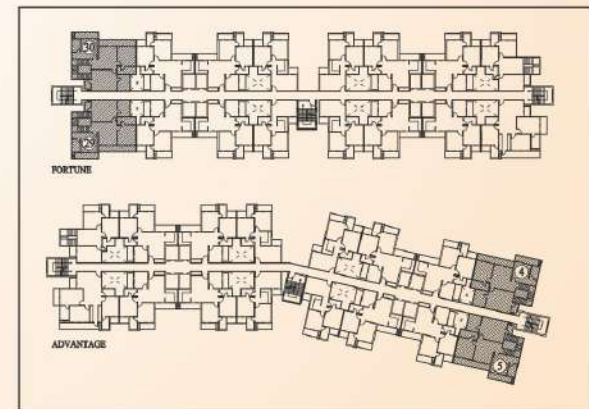

SPECIFICATIONS

Control your home with just a touch.
Anytime. Anywhere.



Disclaimer: The image(s) displayed is only an artistic impression and purely conceptual and constitutes no legal offering.



SMART HOMES

- Light Control
- Climate Control
- Magic button for turning On/Off all lights
- LPG leak detection
- Main entry sensor



LIVING / DINING ROOM

- | | |
|------------------------|----------------------|
| Floors | Vitrified Tiles |
| External Doors/windows | UPVC |
| Paint | Oil Bound Distemper |
| Main Entrance Door | Laminated Flush Door |



MASTER BED ROOM

- | | |
|------------------------|-------------------------------------------------|
| Floor | Laminated wooden flooring |
| External Doors/windows | UPVC |
| Paint | Oil Bound Distemper |
| Internal Doors | Hard wood frame with painted flush door shutter |



Other BEDROOMs

- | | |
|------------------------|-------------------------------------------------|
| Floors | Vitrified Tiles |
| External Doors/Windows | UPVC |
| Paints | Oil Bound Distemper |
| Internal Doors | Hard wood frame with painted flush door shutter |



TOILETs

Floors	Ceramic Tiles
External Windows	Aluminium
Fixtures & Fitting	White chinaware with C.P. fitting
Walls	Ceramic Tiles up to 7 ft
Ceiling	Calcium silicate grid ceiling
Internal Doors	Hard wood frame with painted flush door shutter



KITCHEN

Floors	Vitrified Tiles
External Doors/Windows	Aluminium
Fixtures & Fitting	Granite top with stainless steel sink with C.P. Fittings
Walls	Ceramic Tile upto 2 ft above counter & Oil Bound Distemper
Ceiling	Oil Bound Distemper



BALCONIES

Floors	Ceramic Tiles
Paint	Exterior Grade Paint



MAIN ENTRY LOBBY

Floors	Vitrified Tiles
Paint	Acrylic Emulsion paint

1 KVA Power Backup Free with each flat

Disclaimer: The colour & design of the tiles are subject to availability at the time of construction. All products such as Marble/ Granite/ Wood/ Tiles have inherent characteristics of slight variation in texture color and grain variations and cracks and behavior. The extent/ number/ variety of the equipment/ appliances and their make/brand are subject to availability at the time of construction. The image(s) displayed is only an artistic impression and purely conceptual and constitute no legal offerings.

PROJECT'S SPECIFICATIONS

Total No. of Towers	02 Towers (Fortune & Advantage)	01 Tower (EWS & LIG Tower)
Total No. of Flats	Residential = 917 units	EWS / LIG - 190 units
No. of Floors	Residential - 3 basements + stilt + 30	EWS / LIG - 3 basements + ground + 18
No. of Flats per floor per block/ tower	Fortune - 16 nos. & Advantage -16 nos.	EWS / LIG - 10 nos.
Specifications of lifts	Fortune - 8 nos. & Advantage - 8 nos. (13 Passenges) External door - M.S painted Internal car - stainless steel wall & stone flooring	Tower (EWS + LIG building) - 2 Nos. (13 Passenger Lifts)
Staircase	Flooring - Stone flooring Paint - OBD paint Railing - MS railing	Flooring - Concrete/ IPS flooring Painting - White wash Railing - MS railing
Basement area - Lower, Upper and Third basement	Flooring - trimix/ concrete flooring Lighting - tube lights Paint - Enamel- cement paint	
Club	Banquet hall with kitchen & male female toilets Pre-Function lobby Kitchen with all necessary equipments required for hosting functions/ parties in banquets. Flooring - Vitrified tiles/ marble stone Ceiling - POP false ceiling Table tennis Billards Children Play area Separate male & female spa with jacuzzi, steam, changing rooms & lockers GYM Swimming pool, Kids pool & Jacuzzi Space for Administration & account office	
ESS & DG (Maximum capacity)	DG sets - 1 No. 750 KVA & 2 Nos. 500 KVA Transformers - 2 Nos. 1250 KVA	
Amenities	Green Lawn Kid's play area Water features Jogging Track Multi purpose court	

Note: Other specifications, not mentioned above, is as per Developers/ Architects directions.



The name Mahagun signifies a promise on quality. A promise that has been honoured for more than four decades with innovation in comfort and design. As pioneers in real estate and development, we've completed construction of almost 6.7 million sq.ft. of residential and commercial space. Guided by customer focus and professional expertise honed over the years, we endeavour to continue leading the real estate and development scene in India.

ONGOING PROJECTS



Manorial
The art of Therapeutic Living
Condominiums | Villaments
Sector 128, Wishtown, NOIDA



MAHAGUN
MEADOWS
Sector-150, Expressway, Noida



mezzaria
Luxurious condominiums
Sector-78, Noida



MAHAGUN
MANTRA
Sector-10, Gr. Noida (West)



Marvella
Lavish condominiums
Sector-78, Noida



MAHAGUN
MIRABELLA
Sector-79, Noida



MAHAGUN
MYWOODS
Sector-16 C, Gr. Noida (West)



MAHAGUN PURAM
2,3 BR Homes • NH-24, Delhi NCR

DELIVERED PROJECTS



Mahagun Villa
Vaishali, Ghaziabad



Mahagun Manor
NOIDA
Sector-50, Noida



Mahagun
MAESTRO
NOIDA
Sector-50, Noida



Mahagun
MORPHEUS
NOIDA
Sector-50, Noida



MAHAGUN
SCOT
Crossings Republik, NH-24



MAHAGUN
Maple
2/3/4 BR APARTMENTS
Sector-50, Noida



Mahagun
Mansion
Indrapuram (Ghaziabad)



MAHAGUN
MO SAIC
VAISHALI
Modern Homes. Modest Budget.
Vaishali, Ghaziabad



MAHAGUN
Moderne
Sector-78, Noida



Park Plaza
Shahdara, Delhi



MAHAGUN
SAROVAR PORTICO
delhi ncr - vaishali
A SAROVAR HOTEL
Vaishali, Ghaziabad



MAHAGUN METRO MALL
VAISHALI
Vaishali, Ghaziabad

LOCATION MAP



MAP NOT TO SCALE

Disclaimer : The information and the plans, specifications, design, layout, artistic renderings, images, structural details and other details as mentioned in this Brochure are only indicative and the customers are advised to check and re-verify the information and the plans, specifications, design, layout, artistic renderings, images and other details as mentioned in this Brochure from the website of RERA and/or from the office of the Developer. The depiction of towers and architectural features is purely conceptualize and is based on artist impression to illustrate the appearance of tower once it is completed. No warranty is given that the tower will comply to any degree of this artist's impression. Soft furnishing, furniture and gadgets are not part of the offering. While every reasonable care has been taken in providing the information in the brochure, company, its promoters, officers or its agents cannot be held responsible for any inaccuracies. Fixtures and furnishings and other interiors shown including wall paneling and wall dressings shown in Computer Generated Image and photos are indicative only and constitute no legal offering.

Project Rera Registration No.
UPRERAPRJ2110



MAHAGUN INDIA PVT. LTD.

Corporate Office: Office No. 44, 4th Floor, Tower B, Corenthum,
Sect-62, Noida-201309, India,

Site Address: Plot No. GH-03, Crossing Republik, Dundahera, Ghaziabad (Uttar Pradesh)

LIVING SPACES • WORK SPACES • COMMERCIAL SPACES

Member of
CREDAI