

EXPAND YOUR  
**VIEW OF  
LIFE**



**ELDECO**

OPEN UP  
TO A NEW  
**LIFE**



**ELDECO**

**LIVE BY THE  
GREENS**



**ELDECO**

PRESENTING

**ELDECO**

**PROJECT CODE: EL 150**

**AT SECTOR 150, NOIDA**



**ELDECO**

# ELDECO

## SECTOR 150, NOIDA MASTER PLAN

Water side Cabanas

Round-About  
Feature

Badminton Court

Convenient  
Shopping

Kids Play Area,  
Tot Lot

Seating Areas

Ampitheatre and  
Multi-Purpose Lawn

Grass-On-Slope  
Seating

Rock Climbing,  
Tot Lot

Seating Areas

Skating Rink

Spacious Clubhouse with  
Gym, Swimming Pool,  
Banquet Hall, Billiards,  
indoor Badminton

Party Lawn

Cricket Stadium  
with Academy

Chess Feature

Lawn Tennis  
Court

Half Basketball  
Court

Kid's Play  
Structure

TOWER TYPES  
LIFE (2 BHK)  
VERVE (3 BHK)

Disclaimer: Only Phase-1  
plan is firm. Other phases  
subject to change at  
Company discretion



RERA NO: UPRERAPRJ15172

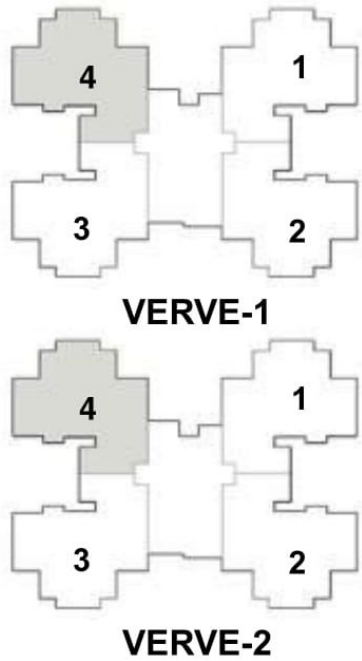

OPENING BOOKINGS

# ELDECO

EL150 (PHASE-1)  
AT SECTOR 150, NOIDA

TOWER TYPES

- LIFE (2 BHK)
- VERVE (3 BHK)

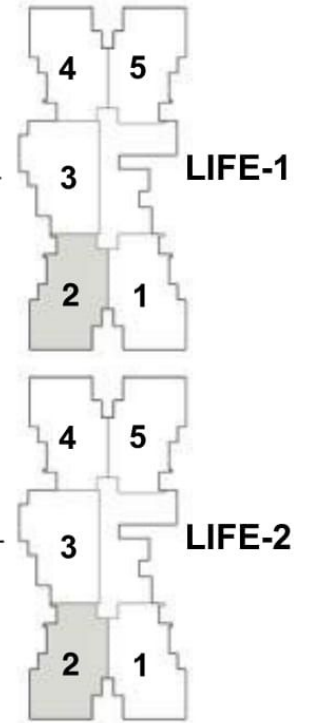

Disclaimer: Only Phase-1 plan is firm. Other phases subject to change at Company discretion

# Live an Active Life

Enter a new life that is active with fun, sports and leisure. A life that offers numerous opportunities to relax and rejuvenate after a hard day at work. Life that brings alive the sportsperson in you. Life that offers numerous social opportunities to meet new people, make new friends or let you be at peace with yourself.

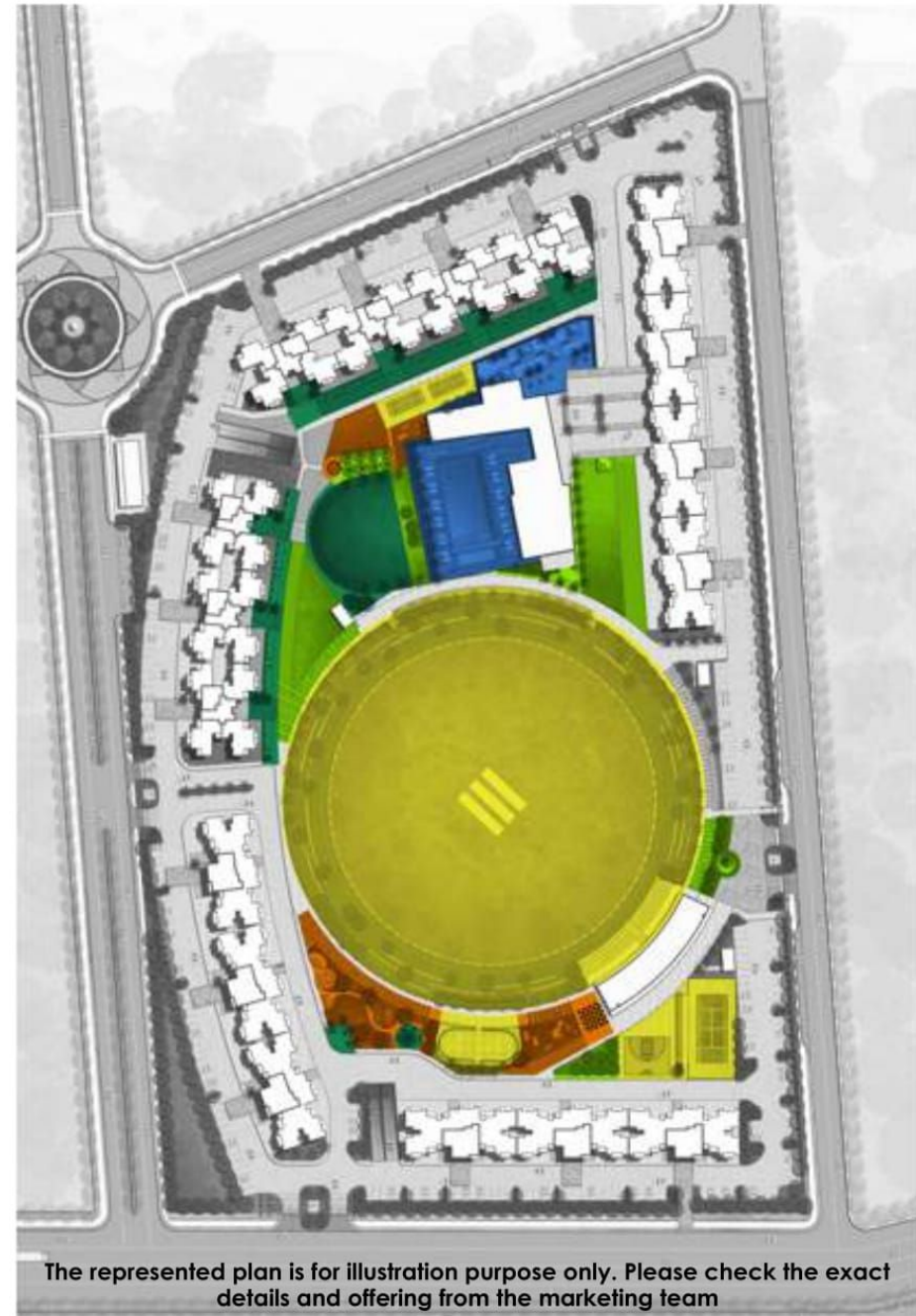

# Live The Way You Would Live In A Resort

- Enjoy resort living
- Swim, relax on loungers, chill under cabanas
- Meet your friends at the café
- Go for a stroll

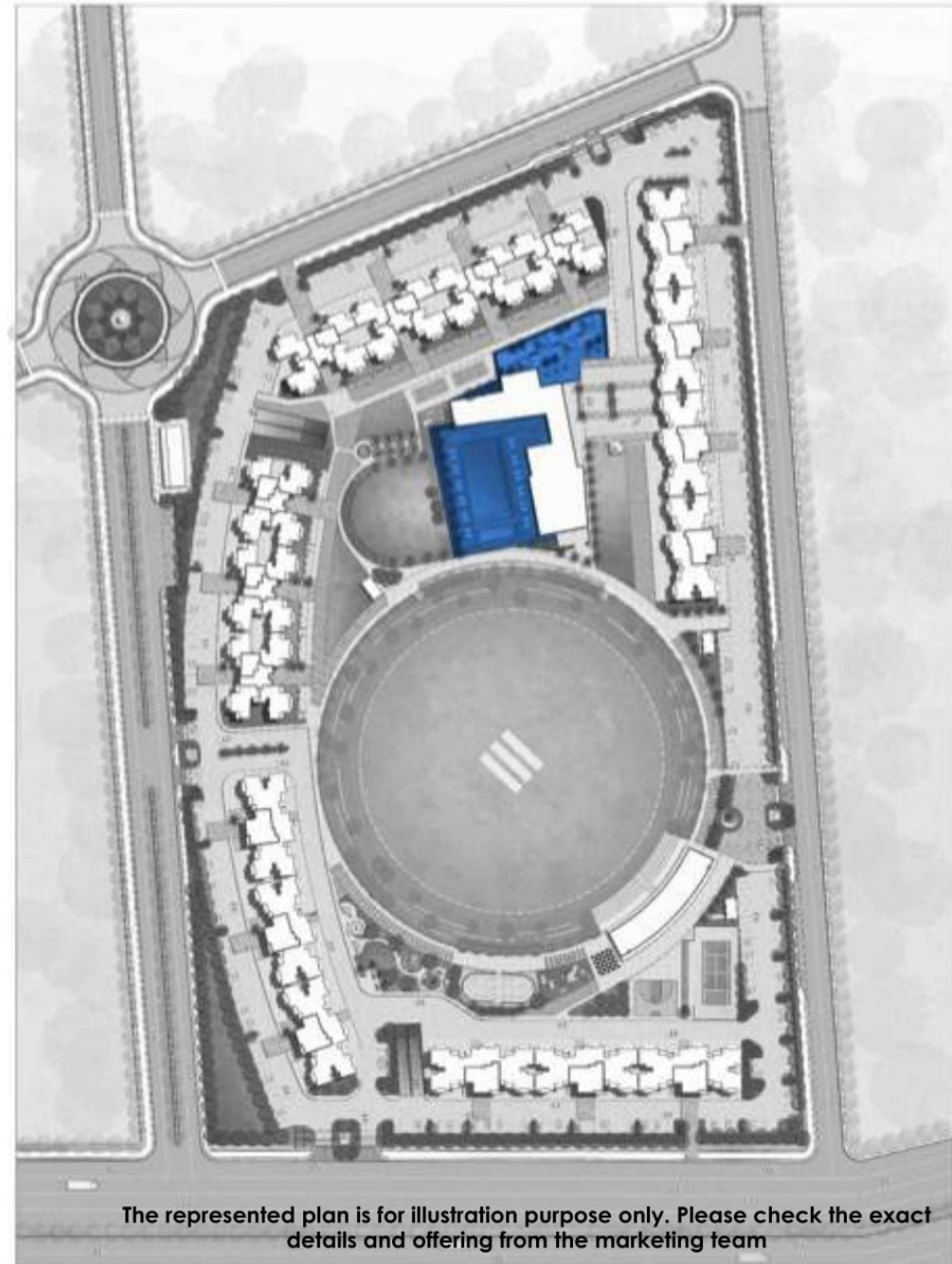



# Live a Sporting Life

Enjoy sporting life. Choose to play what you like.

- A leisurely game of lawn tennis
- A quick round of badminton
- Feel the energy of basketball
- A friendly cricket match
- Play Chess outdoors

Choose the game of life.

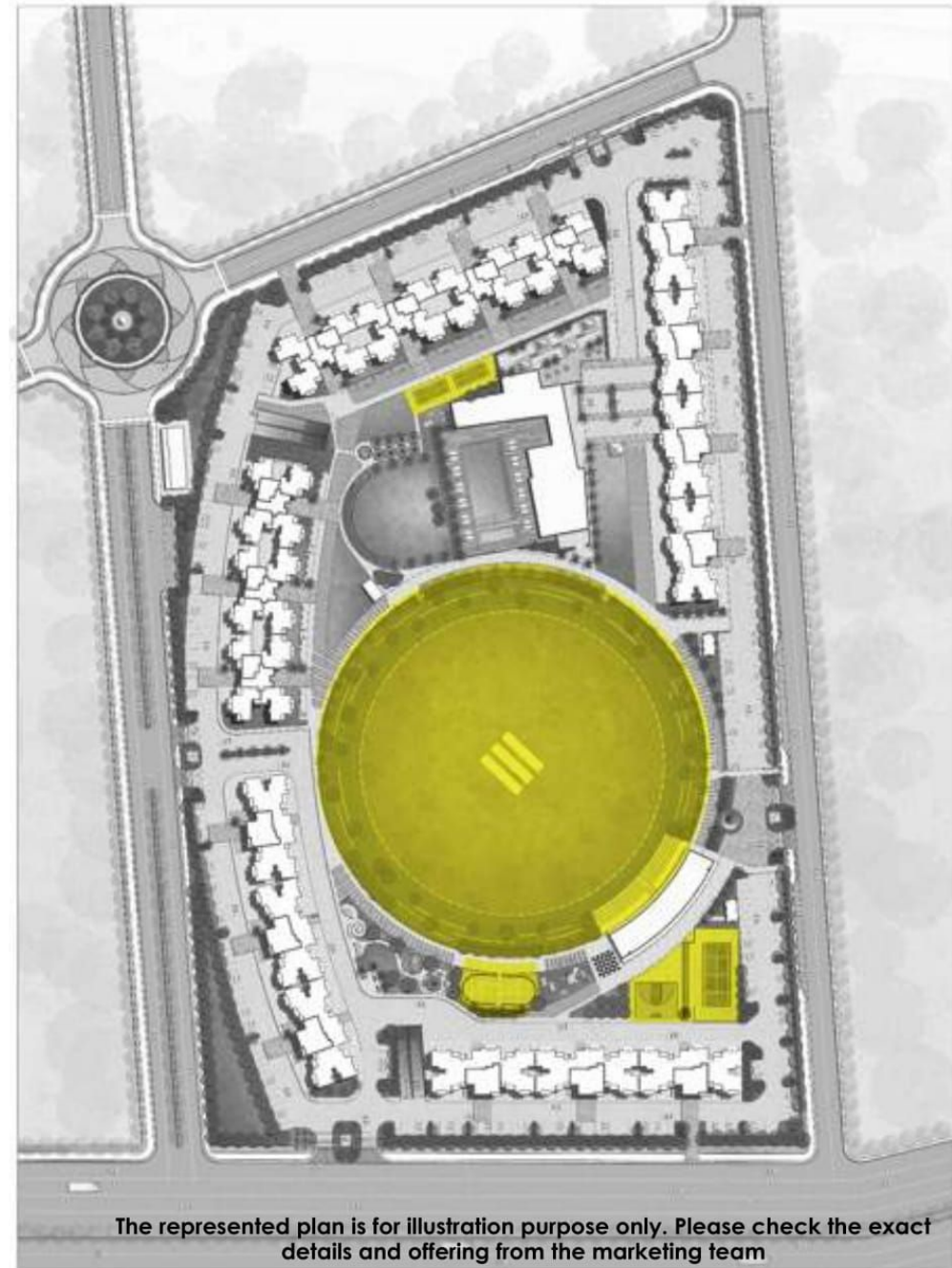

The represented plan is for illustration purpose only. Please check the exact details and offering from the marketing team

# Live an Active Social Life

- Areas designed to cut out the city noise
- Floating seating areas for that evening chat with your neighbour

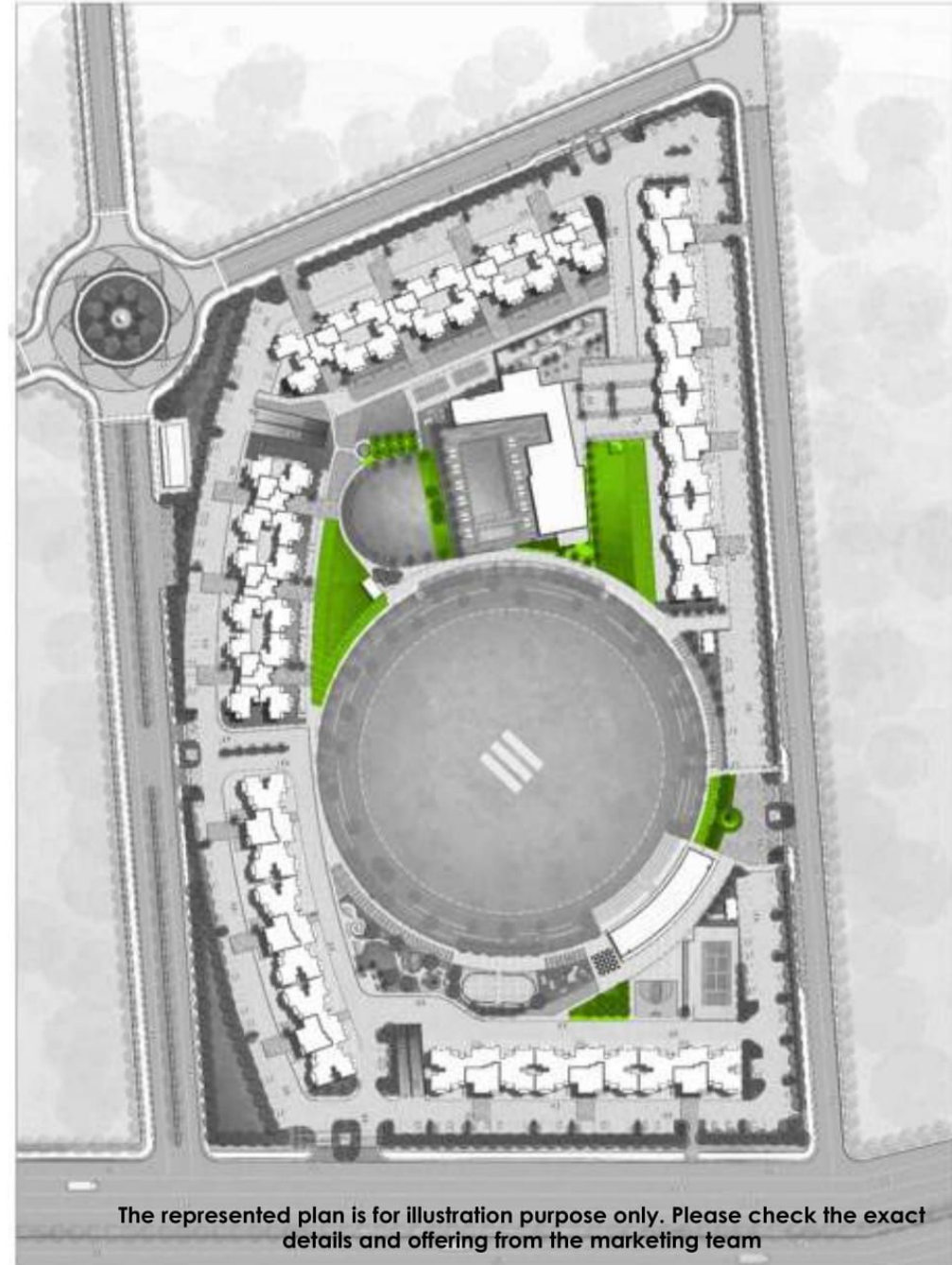

The represented plan is for illustration purpose only. Please check the exact details and offering from the marketing team

# Let Kids Have Fun

- Kids friendly complex with 4 kids' play areas
- Tot lot area for smaller kids with seating for guardians
- Cricket academy and field within the complex

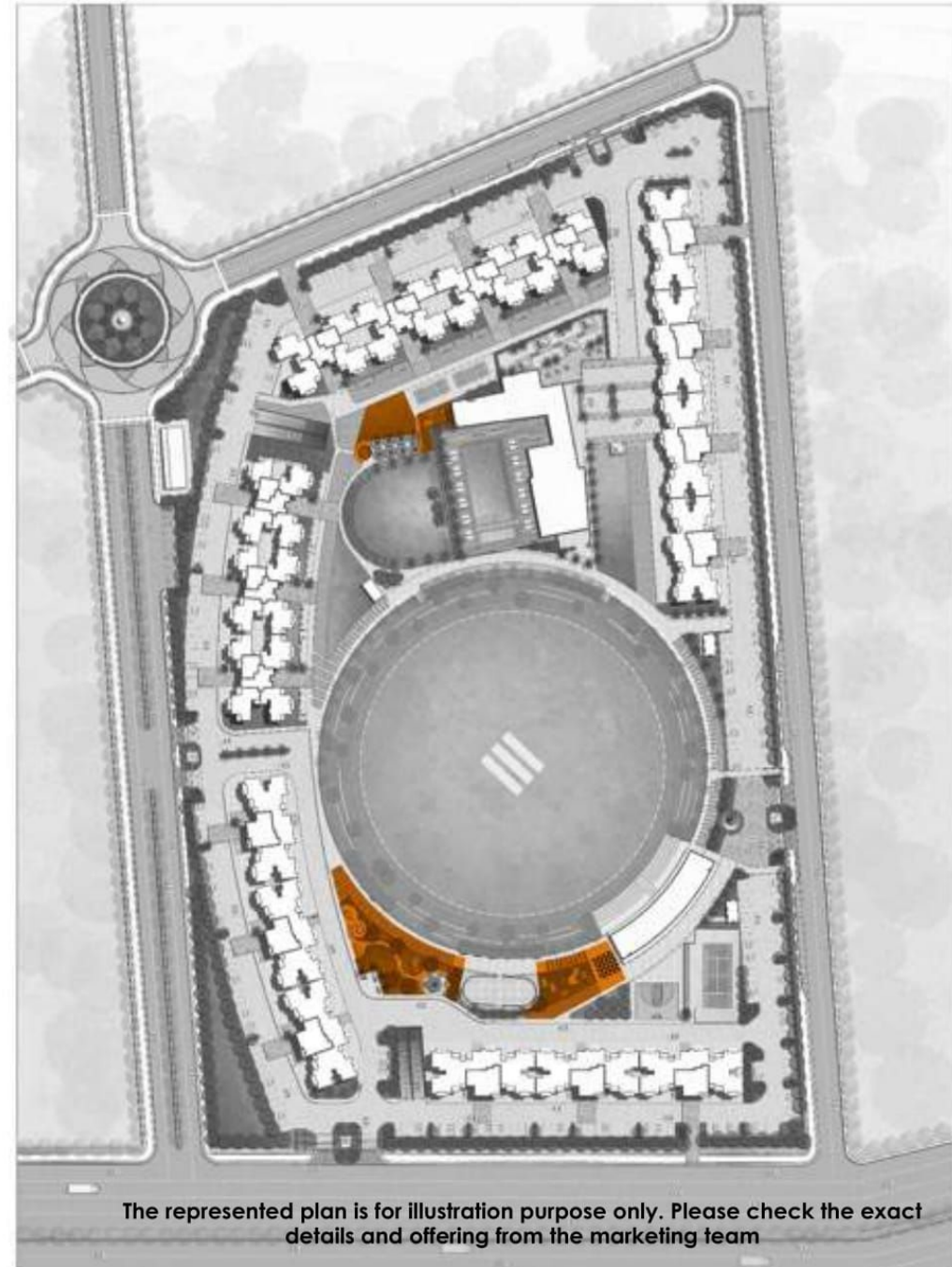

The represented plan is for illustration purpose only. Please check the exact details and offering from the marketing team

# Areas to Discover

- Hang out places scattered all over the complex
- Amphitheatre with grass steps and seating on grass
- Cricket field with grass on slope seating for spectators and pavilion

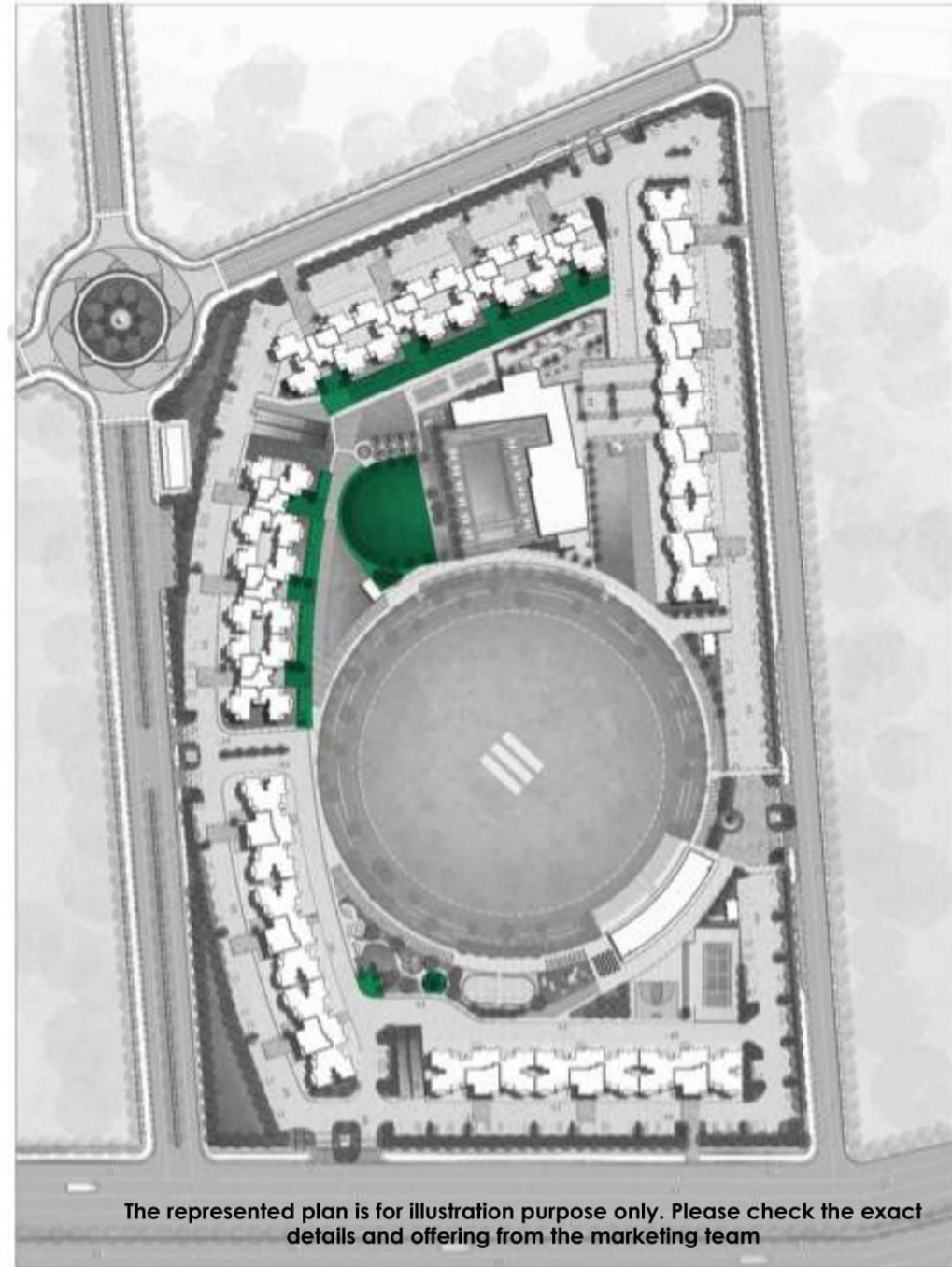

The represented plan is for illustration purpose only. Please check the exact details and offering from the marketing team

# DESIGNED TO LIVE BETTER



## LIVABLE ROOM SIZES

Homes at EL 150 are designed with livable room sizes. The apartment is spacious, aesthetically designed to accommodate what is necessary for contemporary living



## HEALTHY HOMES

Homes at EL 150 are planned for healthy living. Each home is designed for maximum ventilation and natural light. Spacious open greens inside the complex also keeps the environment healthy



## SOCIAL INFRASTRUCTURE

Sector 150, Noida is well located at a prime location with developed social infrastructure in near vicinity



# **Sports City, Sector 150**

---

The Most Sought After  
Location In Noida

# SECTOR 150

## A Perfect Location For The Good Life

This map is not to scale

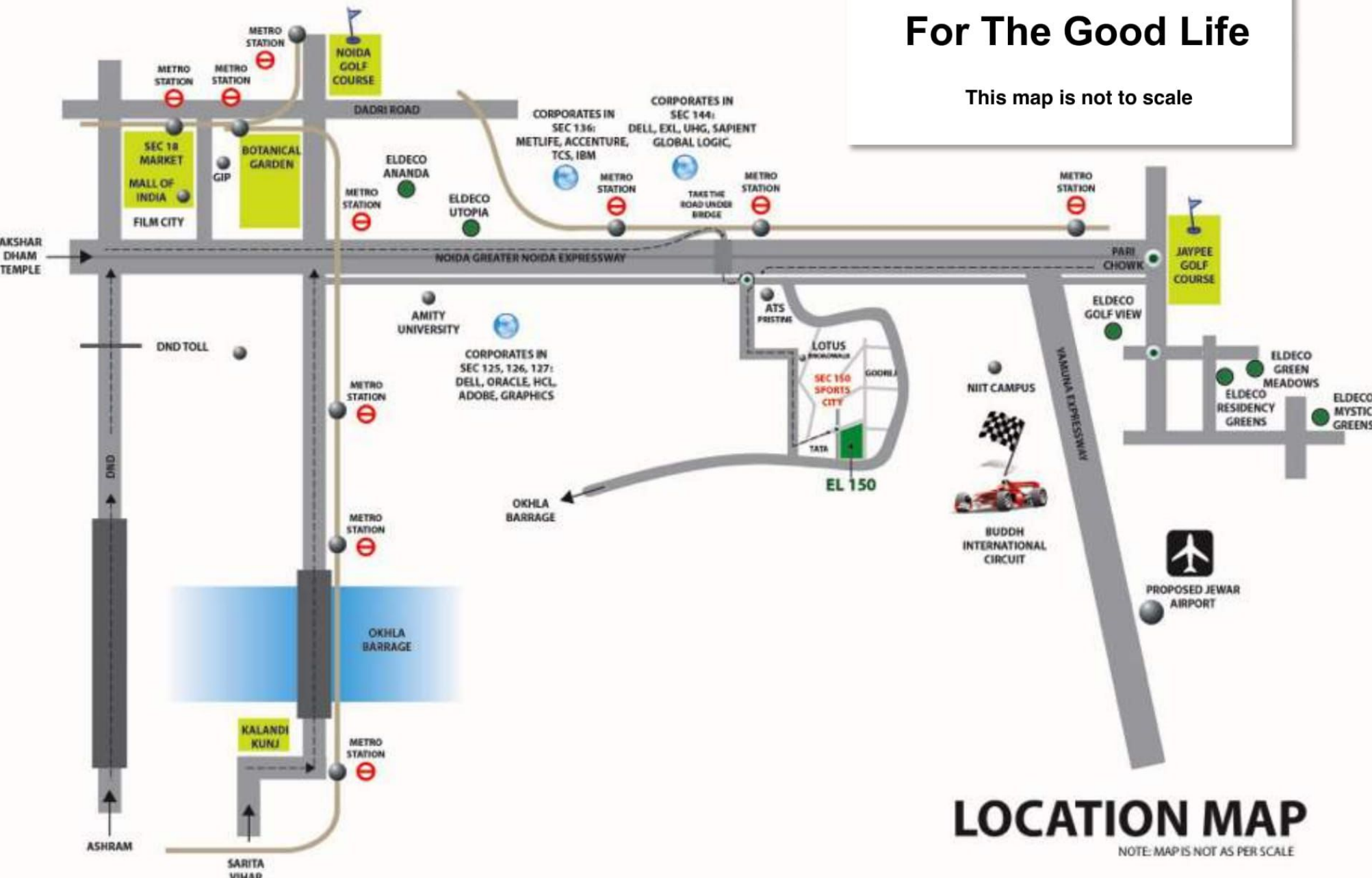

### LOCATION MAP

NOTE: MAP IS NOT AS PER SCALE

# NOIDA HIGHLIGHTS

## Sector 150

### A well connected Location

- 8 Lane DND Flyway connects Delhi to Noida
- Noida- Greater Noida Expressway is a 6 Lane highway connecting Noida & UP to Greater Noida
- Upcoming FNG Expressway will connect all major cities
- Upcoming Noida Greater Noida Metro will pass close to the site. Estimated date of opening: June 2018





# NOIDA HIGHLIGHTS

## Best of Education

LEADING SCHOOLS WITHIN 15 MIN DRIVE

- Amity
- Apeejay
- DPS
- Step by Step
- Shriram Millennium
- Lotus Valley School
- Pathway and many more

### LEADING INSTITUTES

- IIM Lucknow (Part-time campus)
- NIIT, Infosys Education Centre
- Amity Business School
- Shiv Nadar University
- Galgotia University



# NOIDA HIGHLIGHTS

## New Airport at Jewar

- Located at 20 minutes driving distance from Sports City, Sec-150
- As per state government the airport to be operational in the next 5 years
- To have Metro connectivity by extending the current Greater Noida Metro Line from Pari Chowk
- Airport connectivity will encourage MNCs to open their establishments in the vicinity



# NOIDA HIGHLIGHTS

## Best of Healthcare and Sports Facilities

### LEADING HOSPITAL

- Jaypee Hospital
- Yatharth Hospital
- Fortis Hospital

### SPORTS HUB

Proposed Sports City with

- Swimming academy
- Tennis academy
- Cricket academy
  - Golf course
- 4 World Class Golf-Courses in Noida  
and Greater Noida



# NOIDA HIGHLIGHTS

## Best of Social Infrastructure

### ACTIVITIES

- World of Wonders
  - Water World
  - Expo Centre

### SHOPPING IN NOIDA

- DLF Mall of India
- Great India Place
- Sector 18 Market
- Omaxe Connaught Place (Greater Noida)
  - Grand Venice Mall (Greater Noida)
  - Lotus Greens Broadwalk (Sports City)  
*(under development)*

