



**ELECTRONIC
BAZAAR**

GAUR CITY CENTER

GAUR CHOWK, GR. NOIDA (W)

GAUR CITY CENTER RERA REGN. NO.: UPRERAPRJ4780



GAUR CITY CENTER - A PART OF NCR'S LARGEST COMMERCIAL HUB

Gaur City Center is a multi-storey high street shopping destination that is coming up right at Gaur Chowk, Greater Noida (West) with total floor area of 93294.4 Sq. Mtr. (1004220.9 Sq. Ft.) to fulfill your basic needs conveniently. Gaur City Center promises not just to fulfill your daily requirements but also facilitates you an ambiance of its own structure. The place will be exquisite in terms of design and architectural innovations and will cater about 5 lacs residents in the catchment area. Gaur City Center is Pre-certified IGBC Green Building project and is a part of 101171.0 Sq. Mtr. (25 Acre) commercial hub that includes Gaur City Mall, Multi-level parking for around 5600 cars, an upcoming hospital and already operational petrol pump. Gaur City Mall will be one of the biggest pioneer luxury malls in Greater Noida (West). The mall will have the best international brands and exquisite food outlets to meet all your desires.

LOCATION ADVANTAGES



All specifications, images including stock images, colours, pictures and accessories are indicative and used for illustrative purposes only. For the actual project details, please refer to the specifications mentioned in the subsequent page of this brochure.



WING - B

WING - B

WING - A

WING - A

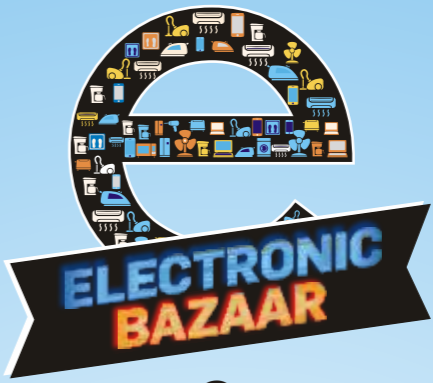

@
GAUR CITY CENTER
 GAUR CHOWK, GR. NOIDA (W)

LAYOUT PLAN

8TH FLOOR (ELECTRONIC BAZAAR)

130 MTR. ROAD

60 MTR. ROAD

SERVICE ROAD

SERVICE ROAD

PLOT LINE

PLOT LINE

PLOT LINE

SERVICE ROAD

SERVICE ROAD

PLOT LINE



WING - B

WING - B



**G AUR
 CITY
 CENTER**

GAUR CHOWK, GR. NOIDA (W)

LAYOUT PLAN

9TH & 10TH FLOOR (ELECTRONIC BAZAR)

WING - A

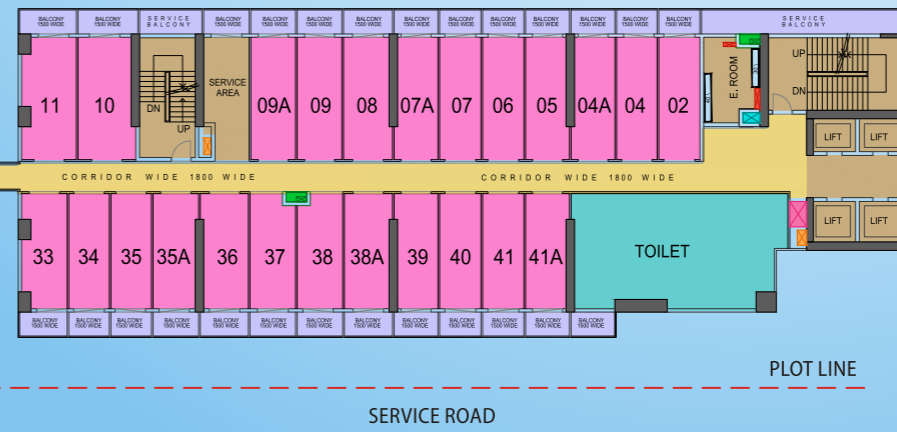

PLOT LINE

130 MTR. ROAD

SPECIFICATIONS

TOTAL NO. OF ELECTRONIC BAZAAR

8TH FLOOR : 142
9TH & 10TH FLOOR : 154

NO. OF FLOORS : Basement 1 + Lower Ground Floor + Ground Floor + First Floor + Second + Floor + 3RD – 17TH Floors (Offices, Hotel and Banquets) etc.

NO. OF LIFTS : Separate Lifts – 2 Sets of 3 Lifts each For Office / Chamber & Whole Sale Markets. Specification of Lifts – S.S Finish from inside and outside

STAIRCASES

- FLOORING : Tile Flooring / Concrete Finish
- PAINTING : OBD Paints
- RAILING : MS Railing (As Per Design)
- LIGHTING : Tube light / Ceiling Mounted Light Fixture

COMMON TOILETS

- Male Toilet, Female Toilet on each floor : Tile Flooring
- FLOORING : OBD Paints
- PAINTING : Tiles till Dado Level
- WALL CLADDING : European W.C
- W.C : Chrome Plated
- CP FITTING

BASEMENT AREA

- ROAD AND PARKING : Trimix Concrete Flooring
- LIGHTING : Tube light / Ceiling Mounted Light Fixture
- COMMON PARKING : 15000 SQ.M approx. as per sanction drawing on paid basis
- RAMP : Chequered Tiles / Trimix Concrete Flooring
- DISABLE PARKING : As per norms

CHAMBERS/OFFICES/WHOLE SALE MARKET

- FLOORING : RCC Slab – Floor Flooring to be done by Buyer.
- WALLS : Partition Dry Walls
- CEILING : Exposed RCC Ceiling (No Furnishing)
- DOORS : Aluminium / UPVC with Glass.
- ELECTRICITY : Dual Meter with Electric Point Cable till Shop
- FIRE FIGHTING : As per Fire NOC

LOBBY AND COMMON AREAS

- FLOORING : Tiles / Stone Flooring
- CEILING : Exposed RCC with running Service Area
- PAINTING : OBD Paints
- RAILING : M.S Railing (As Per Design) with Glass on external facade.
- WALLS : Tube light / Ceiling Mounted Light Fixture
- ELECTRICITY : Plastered Walls with Paints.
- FIRE : Common Area and Corridor Lighting
- FIGHTING : As per NOC

LANDSCAPING

- HARD LANDSCAPE : Tiles / Trimix Concrete / Pavers / Kerb Stone / Chequered Tiles
- SOFT LANDSCAPE : Natural Grass / Artificial Grass pad / Shrubs / Plants / Trees
- LIGHTING : Pole Light

ESS AND DG (MAX. CAPACITY)

- DG SETS : As Per Load Requirement
- TRANSFORMER : As Per Load Requirement

STP

- 535 KLD – 1 No. : Approx. 345 SQ.M (IN BASEMENT-1)

ELECTRICAL PANEL ROOM

- IN BASEMENT : Approx. 230 SQ.M
- FLOORING : IPS Flooring
- WALLS : OBD Paints

Actual Construction Images



All specifications, images including stock images, colours, pictures and accessories are indicative and used for illustrative purposes only. For the actual project details, please refer to the specifications mentioned in the subsequent page of this brochure.

GAUR CITY SITE PLAN



ELECTRONIC BAZAAR



LOCATION MAP

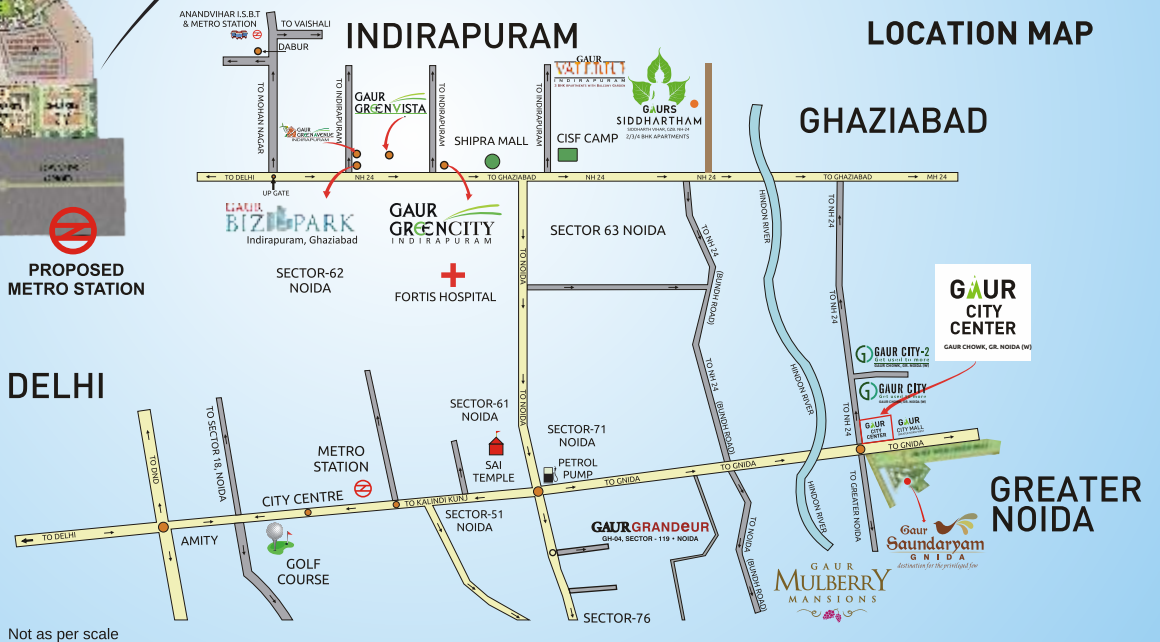

Not as per scale



REAL ESTATE | RETAIL | EDUCATION | HOSPITALITY | SPORTS

Gaursons Hi-tech Infrastructure Private Limited.

Site Office: Gaur City, Gaur Chowk, GH-01, Sec-4, Gr. Noida (West)

Corporate Office: Gaur Biz Park, Plot No.-1, Abhay Khand II, Indirapuram, Ghaziabad-201014.

Member of **CREDAI**



gaursonsindia.com

www.facebook.com/GaursonsIndiaPrivateLimited

www.twitter.com/gaursons_india



GAUR CITY CENTER RERA REGN.NO.:UPRERAPRJ4780

LOAN AVAILABLE FROM :

- PNB Housing** - Ghar Ki Baat
- ICICI Bank Home Loans** - Khayaal Aapka
- CONSTRUCTION FINANCE PARTNER**
- Piramal** - Capital & Housing Finance

24+ YEARS OF UNFALTERING COMMITMENT
25000+ POSSESSIONS GIVEN (2014-18)

45+ SUCCESSFULLY DELIVERED PROJECTS
40000+ SUCCESSFULLY DELIVERED UNITS