

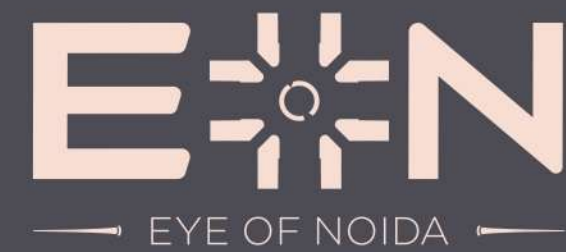

Web- [www.fairfoxinfra.com](http://www.fairfoxinfra.com)

Site/Corporate Office Address: Plot No 01A, Sector 140 A, Noida, Uttar Pradesh - 201305  
PHASE I RERA No.: UPRERAPRJ211016, PHASE II RERA No.: UPRERAPRJ716606

Disclaimer:  
The images, appearances, colours, etc. given herein are mere artistic impression for representation purposes only and do not constitute an offer, an invitation to offer and/or commitment of any nature between the promoter and the recipient. The data/information herein is intended to give a general understanding of the subject matter and is subject to change without any prior notice. Readers are therefore requested to verify all details, including area, amenities, services, terms of sale and payment schedule and other relevant terms independently with the promoter prior to arriving at any decision of buying any plot in the said project. The binding offering shall be governed by the terms and conditions of the Agreement for Sale only. In no event will the Promoter be liable for any claim made by the reader including seeking any cancellation and/or withdrawal for any of the inaccuracies in the information provided in the advertisement, though all the efforts have been made to ensure accuracy. We also do not hold any responsibility for any information provided by any broker/channel partner/property dealer or made available on any website/email communication other than official website/email/correspondence. [1 sq.mt. = 10.764 sq. ft, 1 sq. mt. = 1.196 sq. yd].





FOR THOSE WHO  
CAN SEE HOW  
THE FUTURE  
WILL UNFOLD.





The future is full of opportunities, and it belongs to those who can see it today. Those who can see what will be rather than what is now.

The life we always aspired for, the life we have always wanted to live is not far. It's right in the Eye of Noida.

Presenting

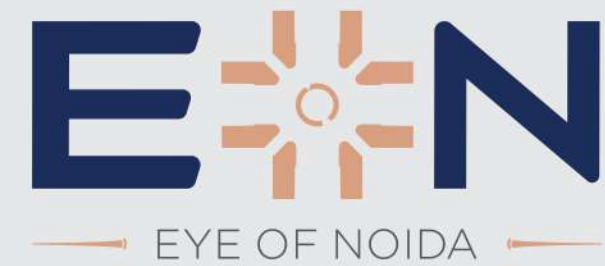

EYE OF NOIDA

# MULTIPLE POSSIBILITIES WITH ONE ADDRESS

Welcome to EON, a perfect combination of retail and IT/ITES office space that matches the best in the world. It is an innovative lifestyle destination with one-of-a-kind multi-sensory experiences shaped by inspirational architecture and world-renowned retailers.

- IT/ITES-enabled corporate park spread across 13.65 acres
- 4 phase development program comprising
  - High-end retail
  - Elegant IT/ITES office spaces
- Grade 'A' Building
- IGBC gold certification compliant development
- Green building



ARTISTIC IMPRESSION

## CIRCULATION

All vehicular circulation is designed for optimal safety and minimal collisions between pedestrian and vehicular movement. The whole complex is connected on the surface as well as an elevated network of skywalks to enable cross-development, barrier-free transit of shoppers, and office goers alike. From the parking floor to the surface, there is an open green plaza with a sculptural staircase



## PLAZA

Four periphery plazas are designated to separate stages with smartly designed drop-off and outdoor, multi-use paved and semi-green zones. One central, 42-meter-wide green avenue, runs across the entire development lined by a variety of outlets.

# A PROMINENT LOCATION



EON is located in the bustling sector 140-A Noida. With its unique dimensions and dynamic facade, this one-of-a-kind architectural landmark will enhance the spirit of Noida. This mixed-use complex is a triumph of creativity and craftsmanship, featuring an office tower and high-street retail zone along with a supercharged fashion and culinary experience.

The location is easily accessible:

- Walking distance from metro Station/FNG/Noida Expressway
- 20 minutes' drive from Jewar International Airport
- 15 minutes' drive from DND Flyway
- 2-5 minutes' drive from nearest Hospital (Felix/Jaypee Hospital)

# SPACE FOR HIGH-END RETAIL

Imagine a retail space where everything is unique, where you can discover and experience tomorrow's trends. As a retailer, you can showcase your brand over different floors. There is easy access to the retail area with pedestrian plazas leading to smaller streets and interactive spaces. For innovative businesses, upcoming retailers, and many more, you get an ideal retail space with EON.





## MORE THAN JUST A PLACE TO WORK

The EON office space is designed with a clear objective in mind: to create a distinctive and energetic environment that everyone who works there can enjoy. Here is a development that places sociability and networking at its very heart. One that encourages interaction and exchange between companies through shared spaces.





LEGEND

1. Vehicular Entrance
2. Vehicular Exit
3. Road to Ramp
4. Road to Shopping Plaza
5. Shaded Avenue
6. Green Boulevard
7. Central Inner Grove with Mound
8. Shopping Boulevard
9. Pedestrian Shopping Plaza
10. F&B Kiosk
11. Double Height Entrance Lobby (30 ft)
12. Project Signage
13. Food Terraces
14. Pedestrian Crossovers
15. Sky Walk
16. Multifunctional Spaces
17. Kid's Play Area
18. Sand Pit
19. Amphitheater
20. Performance Deck
21. Landscape Terraces
22. Tree Bosque Seating
23. Vehicular Boulevard
24. Pedestrian Boulevard
25. Pedestrian Entry
26. Sculptural Staircase-basement Connection

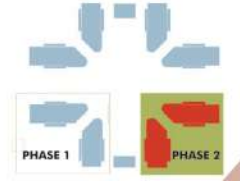

# SITEMAP



All specifications, designs, layout, images, conditions are only indicative and some of these can be changed at the discretion of the builder/architect/authority. These are purely conceptual and constitute no legal offerings. 1sqm = 10,764 sq. ft.

# AXIS FACADES



## INTEGRAL DESIGNS

Integral Designs are landscape architects to a variety of clients from private homeowners, government agencies to real estate companies. They have worked with prominent Indian and International architecture firms.

Their projects span across the globe, from small towns to big metropolitan areas including the Mall of India, Noida, Worldmark, Aerocity & Marriott, Dominica in the past 6 years.

Axis Facades is an international facade consultant with offices in the US, Asia, Middle East, and Europe, having worked on more than 450+ projects in India. Axis Facades currently has 200+ structures underway in three continents spanning across hotel, commercial, office building, retail, aviation spacing, residential etc. Some of their projects are Allianz Tower, Europe, Le Meridien Hotel, East Asia & First International Financial Centre, East Asia.

Over the years they have researched different indigenous materials and have developed a material library to enable architects and clients to understand the different systems and viable options in India and abroad.



ARCHITECTS  
WITH A GLOBAL  
REPUTATION AND  
A SLEW OF AWARDS.

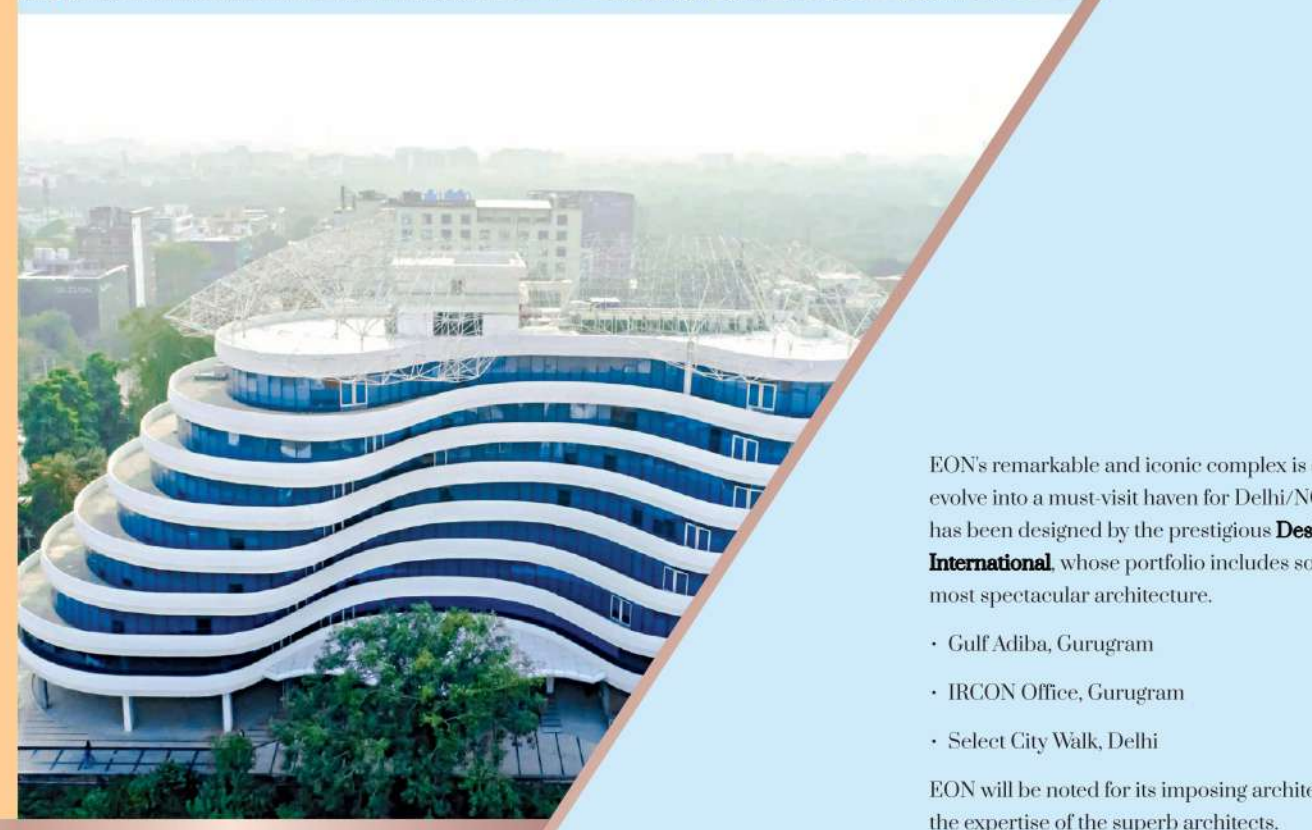

EON's remarkable and iconic complex is destined to evolve into a must-visit haven for Delhi/NCR residents. It has been designed by the prestigious **Design Forum International**, whose portfolio includes some of the world's most spectacular architecture.

- Gulf Adiba, Gurugram
- IRCON Office, Gurugram
- Select City Walk, Delhi

EON will be noted for its imposing architecture, thanks to the expertise of the superb architects.

## GROUND FLOOR PLAN



## FIRST FLOOR PLAN



## SECOND FLOOR PLAN



## 3RD, 4TH & 5TH FLOOR PLAN



### 6TH FLOOR PLAN



### 7TH FLOOR PLAN



### 8TH, 9TH, 11TH & 12TH FLOOR PLAN



### 10TH FLOOR PLAN



13TH FLOOR PLAN

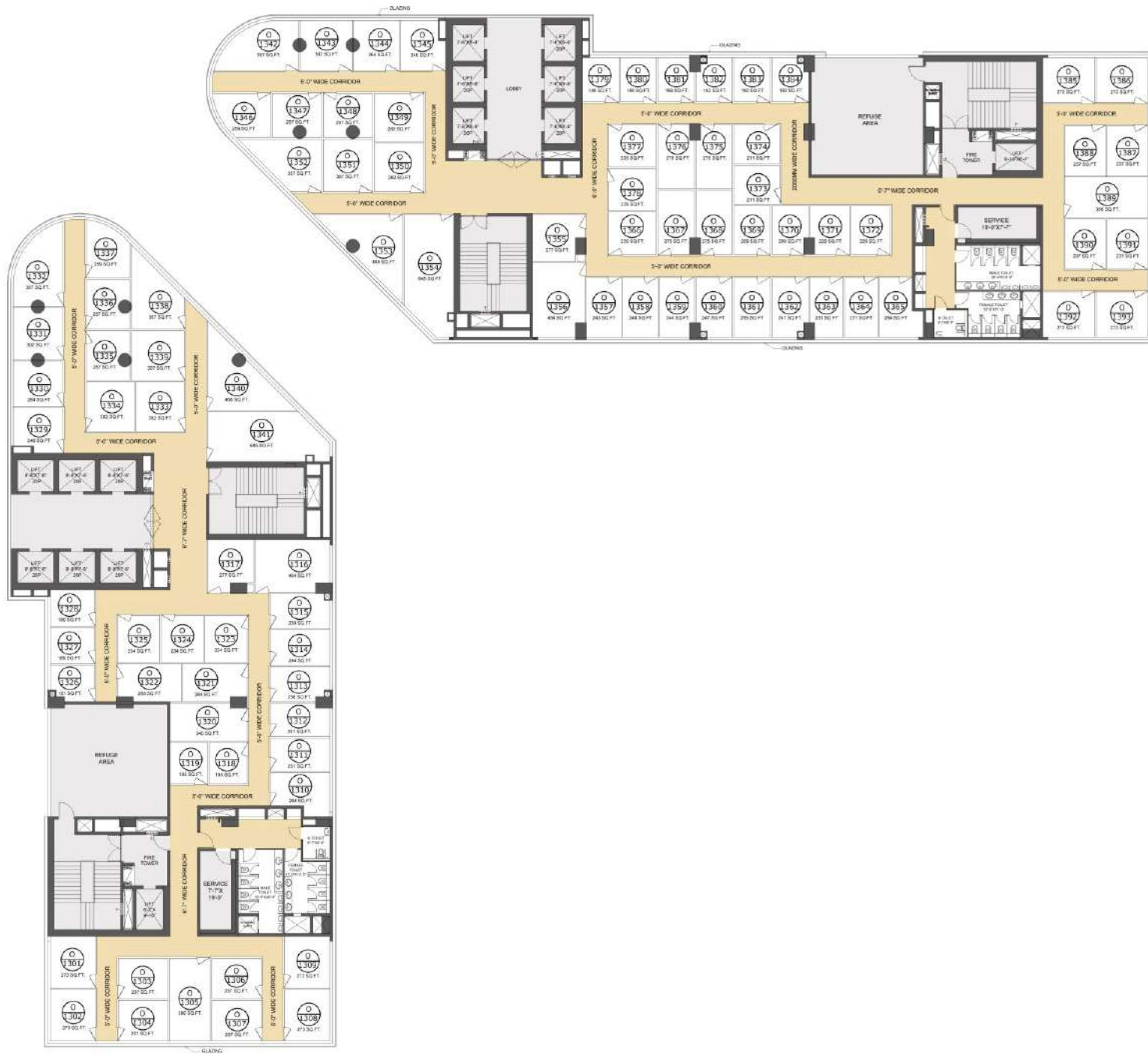

14TH & 15TH FLOOR PLAN





## FAIRFOX IT INFRA PRIVATE LIMITED

A premier real estate development company whose philosophy is based on client satisfaction, execution excellence, and on-time delivery. The company is committed to growing and expanding its horizons by addressing customer needs based upon trust, transparency, and efficiency. With high levels of innovation, product quality, and customer satisfaction, the company aspires to further strengthen the brand. Our professionally managed team enables us to provide complete real estate solutions under one roof including commercial & residential properties to our clients spread across the globe.