



# THE ULTIMATE DESTINATION

The Plush High Street Market,  
Rohini's New **Claim To Fame!**



Sawasdee  
18

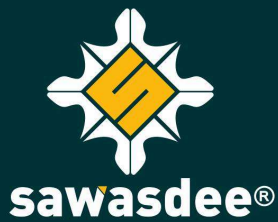

We are a Delhi based group specializing in several verticals including real estate, jewellery, and medical. We are the fastest-growing developer in the Delhi NCR region with our projects in Residential, Commercial, Hospitality and Healthcare developments.

We are developing residential, commercial, industrial and hospitality projects where we have successfully delivered 5mn sq feet of area wherein we have an existing customer base of 10,000+ happy customers within the Delhi NCR region.

## About CMD



**PRADEEP KUMAR AGRAWALLA**  
CHAIRMAN

Mr. Pradeep Kumar Agrawalla is the Chairman of Galaxy Group. Considered as one of the most seasoned realty players in the National Capital Region, Mr. Agrawalla has a rich experience of more than a decade. Originally from Odisha, Mr. Agrawalla is currently the Co-coordinator for "Thai India Cultural Forum" and has also served as the President of Indian Thai Chamber of Commerce and also remained as Director, Board of Trade (Member Director, Joint Foreign Chambers of Commerce).

Mr. Agrawalla's immense understanding of the Indian buyers' preferences coupled with his vast experience, makes him a truly winning combination in the realty space.



## The Plush High Street Market, Rohini's New Claim To Fame!

Centrally and strategically located in Rohini, Sawasdee 18 will unarguably be the sure-shot landmark and the busiest community center of the area. This place will definitely get businesses to the right place with its huge catchment area and most footfalls of serious buyers. For visitors who will frequent this bustling high street market, it will be the one answer to their diverse checklist of needs as well as leisure. As the market will be touted as 'everything under one roof' destination! From cafes to stationers, to chemists, this place will house to just about everything! Little wonder if the best brands start queuing up for a spot in this market. Because business is bound to boom in Sawasdee 18. There are no second thoughts about that.



# PROJECT SPECIFICATIONS

## SHOPS & FOOD OUTLETS

FLOORING, DOORS, WALLS, POWER BACKUP, SHUTTER, FIRE FIGHTING, TOUGHENED GLASSES

## AIRCONDITIONING SYSTEM

DX-SYSTEM, AIR CONDITION IN EACH SHOP

## LOBBY & COMMON AREAS

FLOORING, CEILING, WALLS & PAINTING, RAILING, ELECTRICITY, FIRE FIGHTING, CCTV, STAIRCASE, DRINKING WATER

## LIFT & ESCALATORS

## COMMON TOILETS

FLOORING, CEILING, WALLS, CHINAWARE, C.P. FITTINGS

## BASEMENT AREA

FLOORING, LIGHTING, COMMON PARKING, CCTV, VENTILATION, FIRE FIGHTING

## LANDSCAPING

HARDSCAPE, INTERNAL ROADS, LIGHTING, SOFTSCAPE, CCTV

# SITE PLAN

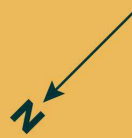

# FLOOR PLAN

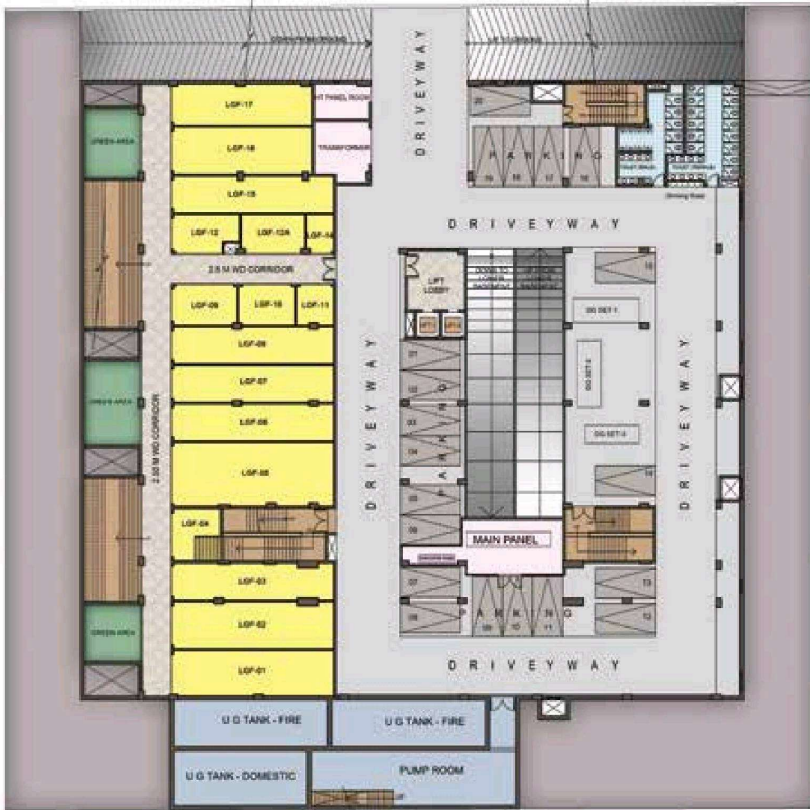

Upper  
Basement

Ground  
Floor

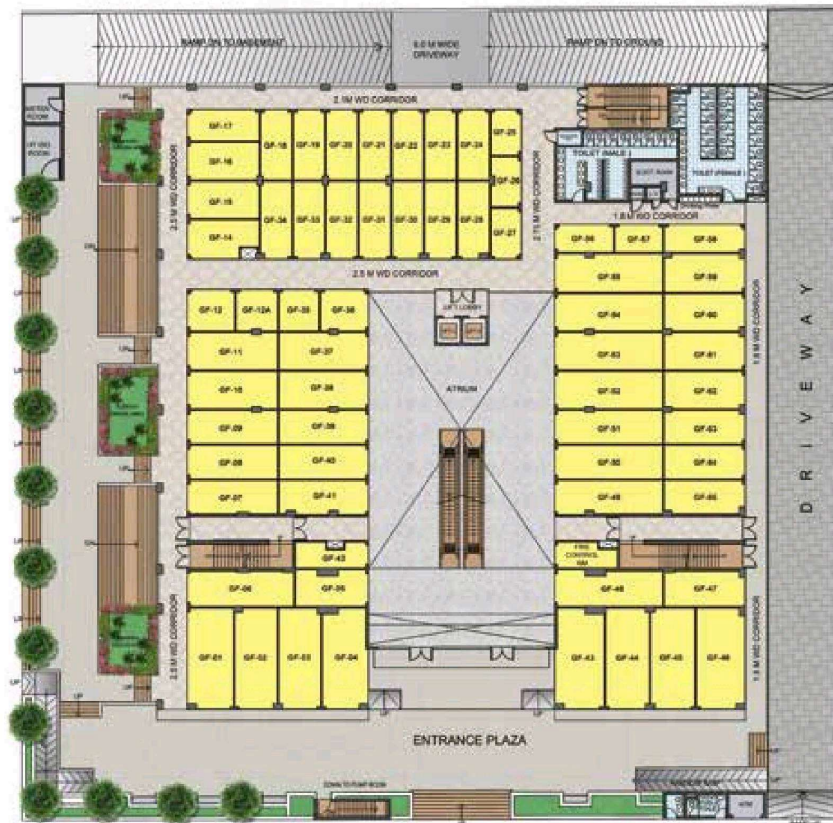

# FLOOR PLAN

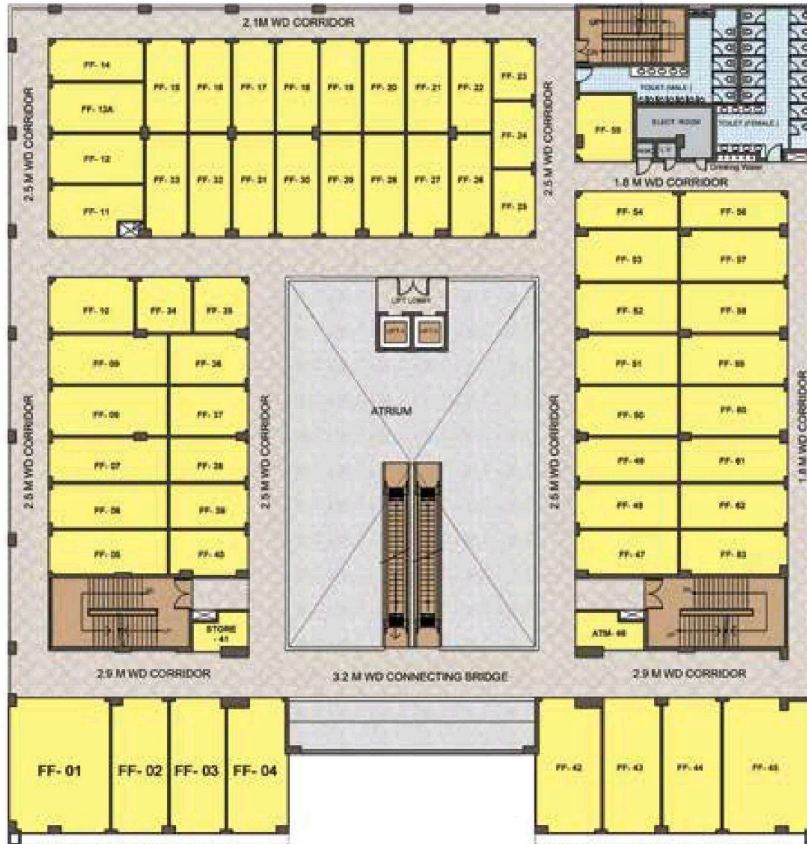

First Floor

Second Floor

